

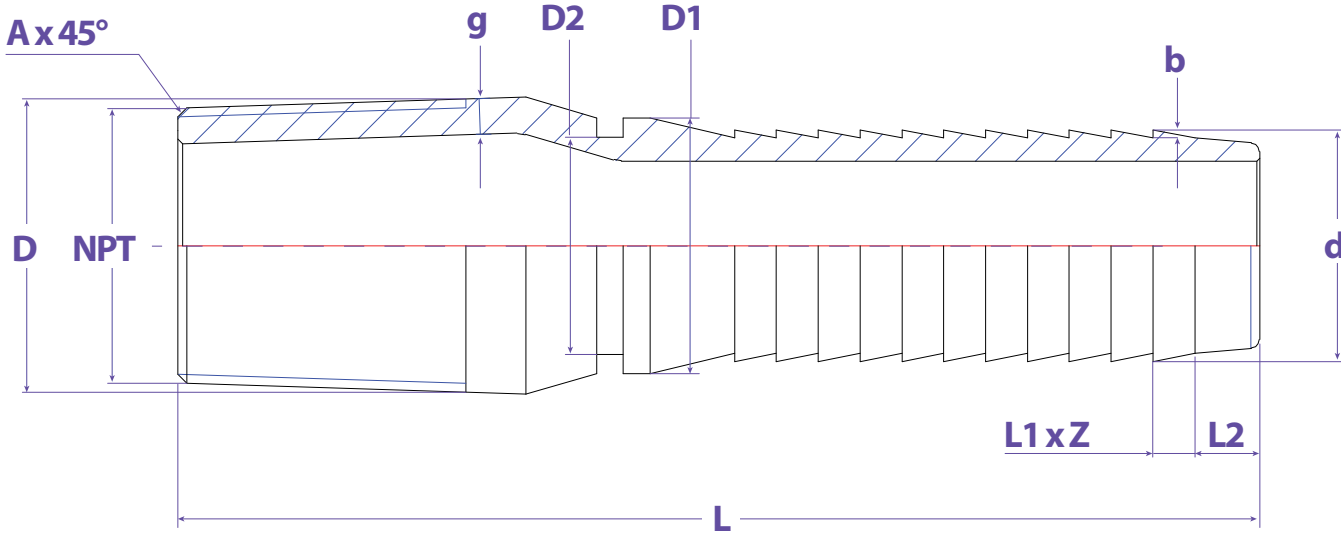

NPT THREADED



FEATURES & APPLICATIONS:

• General Uses:

A camlock fitting is a type of coupling that is used to connecting hose and or pipes together that transfers liquids, powders and granules. A straight through connection is made that maintains the pipe size and allows the free flow of materials being transferred.

Size	Working PSI	D	D1	D2	d	g	b	L1	Z	L2	L	PART #
1" (NPT)	150	1.339	1.268	1.169	1.035	0.134	0.032	0.158	11	0.276	4.528	SF100SS6C
1-1/4" (NPT)	150	1.681	1.520	1.413	1.280	0.142	0.032	0.158	11	0.295	4.528	SF125SS6C
1-1/2" (NPT)	150	1.913	1.677	1.563	1.535	0.146	0.039	0.158	13	0.354	4.764	SF150SS6C
2" (NPT)	150	2.382	2.185	2.059	2.032	0.154	0.039	0.197	11	0.394	5.236	SF200SS6C
2-1/2" (NPT)	150	2.874	2.752	2.610	2.532	0.205	0.039	0.197	12	0.394	5.906	SF250SS6C
3" (NPT)	150	3.500	3.315	3.150	3.032	0.217	0.047	0.197	16	0.394	7.008	SF300SS6C
4" (NPT)	150	4.500	4.310	4.158	4.032	0.236	0.047	0.197	18	0.433	7.598	SF400SS6C
6" (NPT)	75	6.626	6.358	6.181	6.047	0.280	0.059	0.256	19	0.472	9.331	SF600SS6C

WARNING:

Cam & Groove Couplings should **NOT** be used with any compressed gas, including steam or air. Metal fittings should **NOT** be used with Polypropylene Cam & Groove. Dust Caps and Dust Plugs are **NOT** designed for pressure applications.

Note: All Seal Fast Cam & Groove Stainless Bodies are 316 Investment with 304 Handles.

TITLE CRIMPTEK COMBO NIPPLES - NPT THREADED

DISCLAIMER

All drawings and specifications are subject to change without notice. Drawings represent general dimensions of our products. Seal Fast cannot guarantee the dimensions in the drawing will exactly match those in the drawing. This drawing is the property of Seal Fast Inc. Copying or reproduction of this drawing is expressly prohibited.

MATERIAL

SUS 316

DRAWING NOT TO SCALE

PART #

SF...SS6C

